

# FALCON II

## Quick Start Guide



1

Unpack Falcon II skates and accessories.

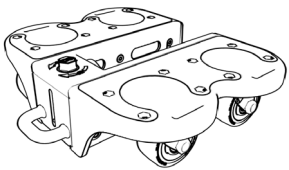

Falcon II skates

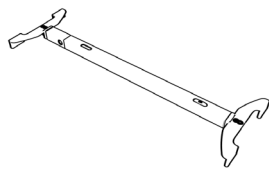

Connector bars

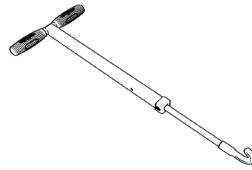

Pull bars

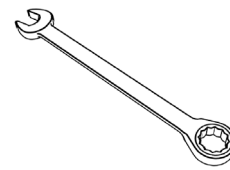

Ratcheting wrenches

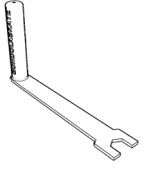

Leveling foot wrenches

2

After removing the gondola kick plates, connect each skate using connector bars, and then install skates to leveling feet.

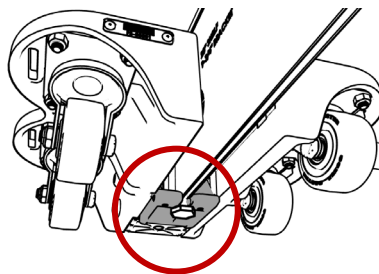
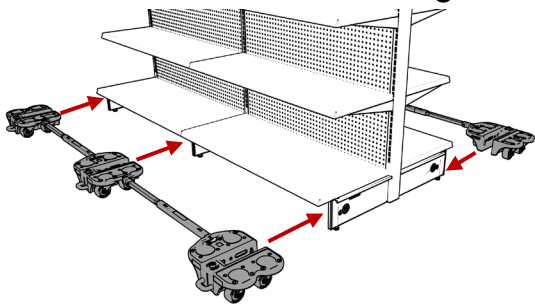

Make sure you cannot push skate under any farther.

3

Raise the lift mechanism on each skate. Make sure the fixture is raised sufficiently off the ground using the leveling foot wrench.

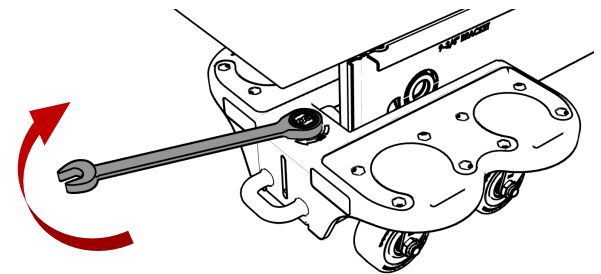

4

Mobilize gondola using the pull bar inserted into the pull hook on the skates.

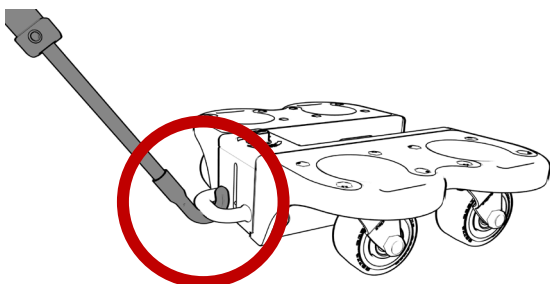

5

Lower fixture and remove skates.

